



SPECIAL ACADEMIC PROGRAM

Path to Graduate School



ABOUT FSU

- Located in Tallahassee, Florida, the **state capital**
- Ranked **19 among national public universities** by U.S. News & World Report
- Ranked **58 among all U.S. universities** by U.S. News & World Report
- **1 of 3 preeminent universities** in the state of Florida
- Home to the **world-renowned National High Magnetic Field Laboratory**
- **Founded in 1851** with a student enrollment of 42,000
- **Over 2,500 international students** from more than 130 different countries and areas
- Ranked in the **top 10** among the most beautiful campuses in the U.S. in 2016



PROGRAM OVERVIEW

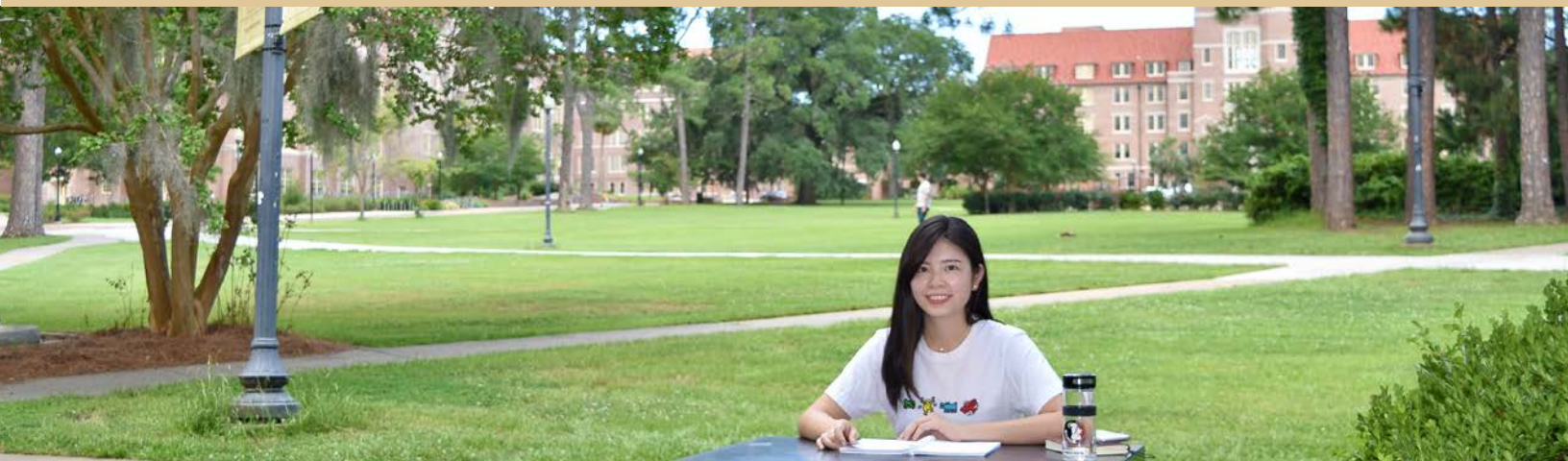

CHOOSE FROM 2 PATHS TO GRADUATE SCHOOL

Path 1: For Senior Students

(In China, this type of program is called 3+1+Master's)

For **RISING SENIORS*** from FSU's partner universities who want to complete the final year of their bachelor's degree at FSU and earn credits to graduate from their home university.

For a list of current partner universities visit global.fsu.edu/sap/partner-universities.

Path 2: For Recent Graduates

(In China, this type of program is called 4+1+Master's)

For **RECENT GRADUATES** who are interested in a graduate program in the U.S. and want to strengthen their academic or English skills and acclimate to American culture.

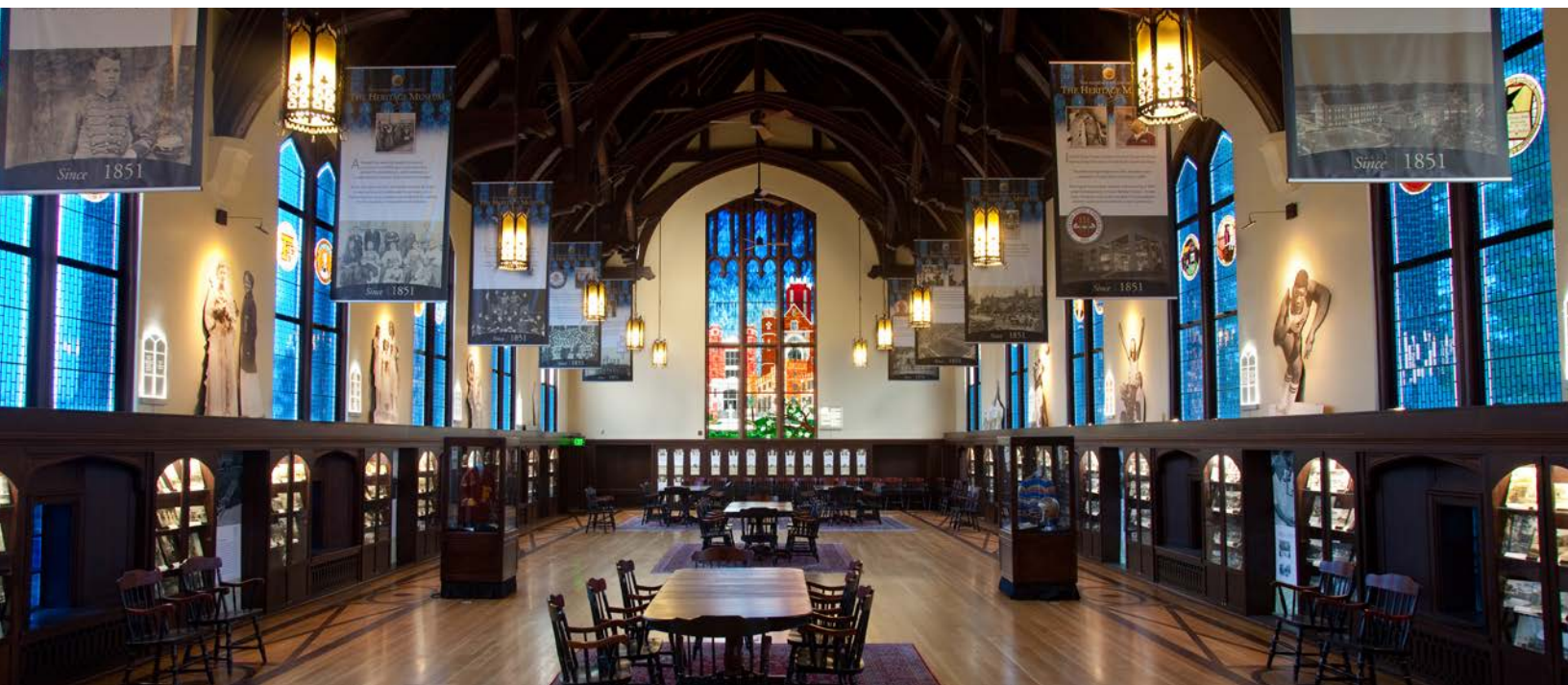

PATH 1: 3+1+MASTER'S

RIISING SENIORS from FSU's partner universities and students who have completed all but the final year of the bachelor's degree program may apply to study 2 semesters at FSU as a non-degree student.

Students need pre-approval from the home university to ensure the FSU credits will count toward the bachelor's degree.

Senior Year Fall Semester

- 4-5 undergraduate-level prerequisites required by the FSU academic department and approved by the home university.

Senior Year Spring Semester

- Combination of 4 undergraduate and/or graduate-level courses.

Transition to Master's program

- Students apply to a master's degree program in spring semester of the pathway program through the FSU admissions portal and submit all of the required documents, such as: GRE/GMAT score, TOEFL/IELTS score, official undergraduate transcripts, three letters of recommendation, personal statement, and resume/CV.
- Students who are admitted to a master's degree program will be degree-seeking students and pay out-of-state tuition and fees.
- Up to 12 credits (4 graduate-level) courses taken during senior year at FSU may count toward the master's degree. Students who transfer 12 credits to the master's degree may generally complete it in 3 additional semesters (additional time for thesis or internship).¹
- The master's degree programs in business allow students to graduate in 3 semesters (typically summer, fall, spring) and no credit can be transferred from the pathway program.



PATH 2: 4+1+MASTER'S

Students who have already completed a bachelor's degree and want to earn a master's degree in the U.S. may apply to study 2 semester at FSU through this pathway program, and receive Conditional Admission to the master's degree program.¹ Once students achieve the FSU academic department's requirements they are officially admitted to the master's program.²

There are two study tracks for students who have already completed a bachelor's degree:

1. Academic Track

- For students who have met the English proficiency requirement but who have:
 - missed the normal graduate application deadline,
 - want to pursue a master's in a different academic field, or
 - want extra staff support and time to adjust to academics in the U.S.
- Students on the academic track take a combination of undergraduate prerequisites and/or graduate-level courses during fall and spring semester, and up to 4 graduate-level courses (12 credits) taken during the graduate pathway program can count toward the master's degree.¹
- Students who transfer 12 credits to the master's degree may generally complete it in 3 additional semesters (additional time for thesis or internship).

2. English-Language Track

- Students who have not met the required English proficiency for their academic program will study English full-time at the Center for Intensive Studies located on FSU's campus.³
- Students do not receive academic credit for English study but have the opportunity to achieve the English proficiency score needed to be officially admitted to the master's degree program.

¹ The College of Business (majors in Finance and Marketing/General Business) does not offer conditional acceptance for graduate degree programs nor does it allow credit taken during the pathway program to count for the Master's degree program since all of their master programs are already designed to be completed in three semesters.

² The offer of conditional admission expires at the end of the 2-semester pathway program and students who have not achieved the conditions by this time will have to apply separately for admission to the master's degree program.

³ Students with English scores of 65 TOEFL or 5.5 IELTS will likely be able to achieve the required 80 TOEFL or 6.5 IELTS within the 2-semester special academic program.



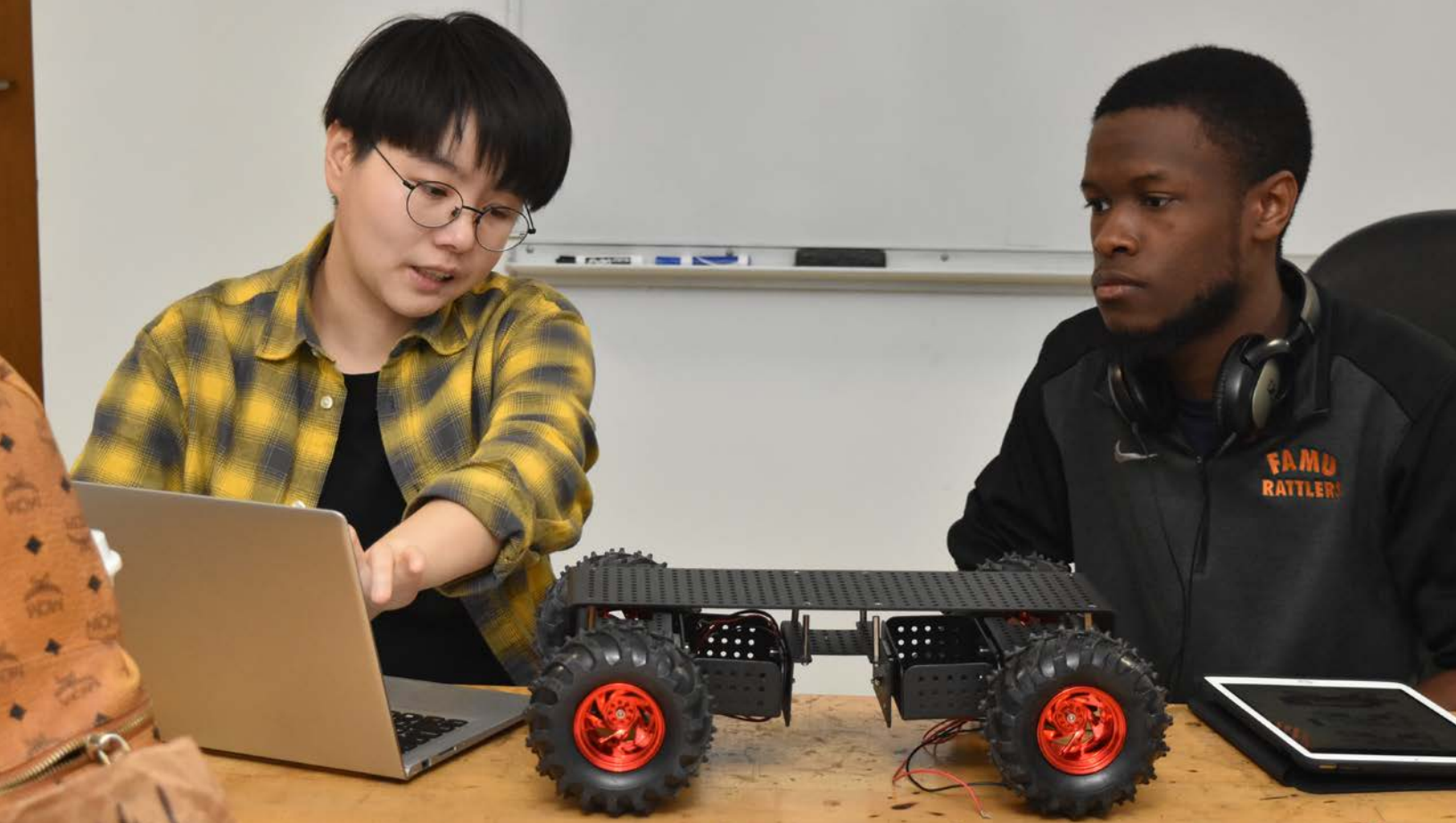

AVAILABLE MAJORS

College of Arts & Sciences

- Geology
- Financial Mathematics

College of Business

- Finance
- Marketing/General Business

College of Communication & Information

- Media & Communication
- Advertising & Public Relations

College of Education

- Curriculum & Instruction (emphasis in Foreign & Second Language Education)

College of Engineering

- Chemical & Biomedical
- Civil & Environmental
- Electrical & Computer
- Industrial & Manufacturing
- Mechanical

College of Social Sciences & Public Policy

- Public Administration
- Public Health

For course information and sample schedules of fall and spring courses, visit fla.st/34gYwa6.



STUDENT SUCCESS & RETENTION

- Complete prerequisite classes for graduate study while earning credits toward your future master's degree program*!
- Meet and work with FSU faculty members to help you choose a research supervisor!
- Learn how to succeed in a U.S. graduate program!
- Complete your bachelor's degree while preparing for your master's degree program!



RETENTION

97% of participants who applied for the master's degree program at FSU were admitted.

94% of participants were admitted to graduate programs or internships in the US, UK or Australia after completing the program.
Of these, **85%** chose to remain at FSU.

94% of engineering and public administration participants applied and were admitted to FSU for a master's degree program after completing the program.

25% have continued on to PhD programs at FSU.

*Business majors do not allow credit to transfer into the master's programs. These are already accelerated master's programs designed to be completed in 3 semesters (1 year).



"I am now a master's student at FSU studying public administration, which ranks among the top 30 MPA programs in the U.S.

This program allowed me to enroll in four graduate courses before I started my graduate program. It helped me prepare for my life as a graduate student and saved lots of time as well."

Yun Chen
Public Administration

ELIGIBILITY, DATES & COST

PROGRAM ELIGIBILITY

- TOEFL iBT Test: 80 or IELTS: 6.5 (*unless participating in the English language track*)
- GPA: 3.0/4.0 or 3.75/5.0
- GRE/GMAT exam results (optional but recommended for students applying for the 4+1+master's)
- Senior or recent graduate

PROGRAM DATES

End of August – Beginning of May

PROGRAM COST

The Program Fee is \$32,500* and includes:

- Tuition for 2 semesters
- Housing
- Meals throughout the program (except during university breaks)
- Program support

In addition to the program fee, students are responsible for:

- SEVIS and visa application fees
- Flights
- Medical insurance
- Textbooks and personal expenses

*Program fee is subject to change. Check global.fsu.edu/sap for all current rates.



"This program helped me become a stronger candidate for graduate school because it let me experience American teaching style and campus life in the U.S."

Xiaomin Xu
Finance



“We have the most professional director, a good environment for study, and the ability to make friends with other international students. You cannot miss this amazing program.”

Jiajian Wen
Finance

HOUSING



Students live in a residence hall conveniently located near FSU's main campus.

Housing details for the upcoming academic year will be provided at the time of application.

Housing amenities & services (no extra charge):

- Fully furnished, including bed linens
- Private bathroom
- A/C and WiFi in all rooms
- Fitness center
- Housekeeping
- Receive packages in the building
- Study rooms
- Lounge with games and computers
- Bus stop directly outside
- 24-hour resident advisors
- Security on premises

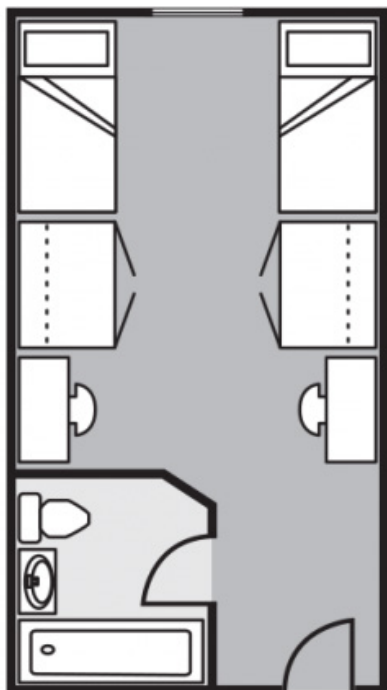

Sample Floor Plan & Bedroom from the 2019-2020 Academic Year



STAFF SUPPORT

Dedicated staff to help students excel academically, socially, and culturally:

Pre-arrival support

- FSU admissions process
- Visa and immigration assistance
- Immunization clearance

Arrival support

- Airport pickup
- Orientation and campus tours

Ongoing support

- Academic support
- Regular check-in meetings with CGE staff
- Organized activities, including shopping, sporting events and other activities
- Immigration workshops
- Intercultural communication and American classroom culture workshop

Transition to graduate school

- Support for master's degree applications
- Resume and personal statement writing workshops
- Guidance in searching for research supervisors

FSU Student Mentors

- Cultural resource to explain U.S. customs and answer questions
- Connect new students to other FSU students and student clubs
- Facilitate activities and excursions on campus and around Tallahassee



"The reason I love this program is that the support team is so awesome, and it helps a lot from every aspect in the U.S."

Chenxing Hu
Communication



OTHER STUDENT SERVICES

Student services:

- Career Center
- Health & Wellness Center on campus
- Counseling services
- Tutoring
- FSU Libraries



"If you want to enjoy American college life and gain professional knowledge about your major, FSU is a good choice for you."

Donghao Ye
Electrical Engineering

CAMPUS LIFE

Campus life:

- On-campus cinema
- Gaming center
- Student tickets to football, baseball, women's soccer, etc.
- Recreation center with olympic-sized pool
- Social events (dance parties, weekly International Coffee Hour, etc.)
- The Rez: a beautiful park with lake and outdoor activities
- FSU Circus
- Student performances (music, vocals, theatre, dance, etc.)





Sporting Events



FSU Circus



Gaming Center



On-campus Cinema



Rec Center with Olympic Pool



The Rez

“I appreciate this program, because I gained a lot. I had to read about 200 page articles per week, and it was a big challenge for me. Most of time it was like reading lots of separated letters. However, Jocelyn, the program director, used her free time to teach me how to read efficiently when she heard I was having trouble.

The other program staff helped me with other challenges I encountered. They also brought us to different school events to help us get to know American school culture well. I feel lucky that I attended this program.”

Jingwen Li
Public Administration



APPLY

SUBMIT YOUR APPLICATION: bit.ly/sapapply

Required uploads for the application:

- English Proficiency Score (TOEFL/IELTS)
- Transcript with English Translation

ADVICE FOR INTERESTED STUDENTS

Plan ahead:

- Begin studying English immediately
- Register to take the TOEFL/IELTS early; there is a 3-month wait time in China

Register your interest well in advance:

- Speak to your professors about the opportunity
- Contact the program team at FSU

Apply by the deadline: April 1!



"I think this program is very beneficial for the Chinese student who decides to go abroad. The staff here is very nice. They will help you to be familiar with the different culture and lifestyle. This program is not only about learning overseas, but also about getting the social experience. You will become more confident to overcome your master's degree program."

Zixuan Wang
Master's in
Business Administration

CONTACT US

FOLLOW US ON WECHAT & WEIBO



CONTACT US

Email: global-programs@fsu.edu



Dr. Jocelyn Vaughn
Program Director, FSU International Initiatives

WeChat: [jmvaughn](#)



VISIT OUR OFFICIAL WEBSITE

For more information about the Path to Graduate School program, visit our official website at global.fsu.edu/sap, or scan the QR Code.

